



ASSEMBLY - EDGE BOUNCE

FOR IPAD MINI / 9.7" / 10.2"

- 1** Remove the packaging insert (meant to hold the shape of the case in transit).

Please recycle the insert.

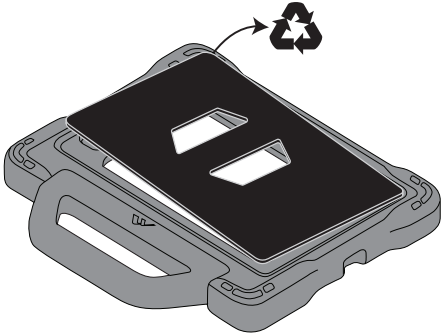

- 2** Peel off protective film from the underlay.

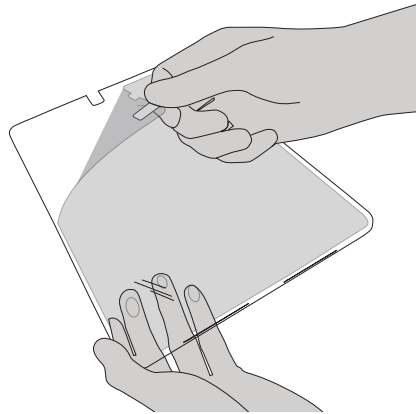

- 3** Install the underlay UNDERNEATH the iPad, ensuring the cutouts are aligned with the camera hole and the matte side is facing out.

Flex corners of case to insert iPad.

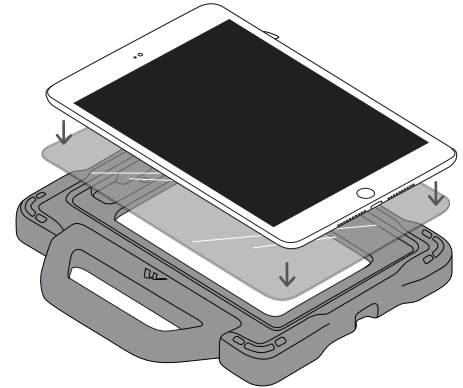



FEATURES:

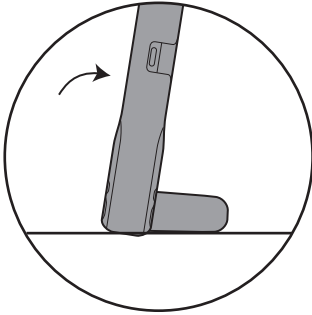

Viewing Mode

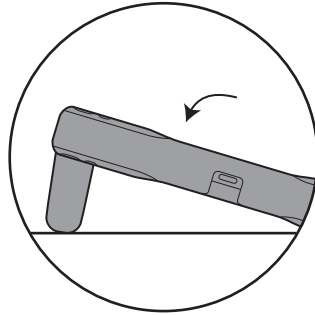

Typing Mode

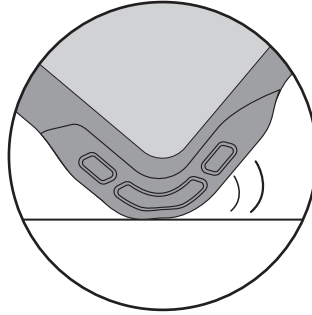

Crumple-zones
absorb impact

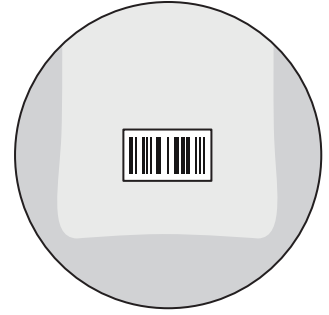

CLEAR Underlay ALLOWS
SCANNING OF DEVICES
and extra protection